

Sectiune /Section 1-1

sc. 1:20

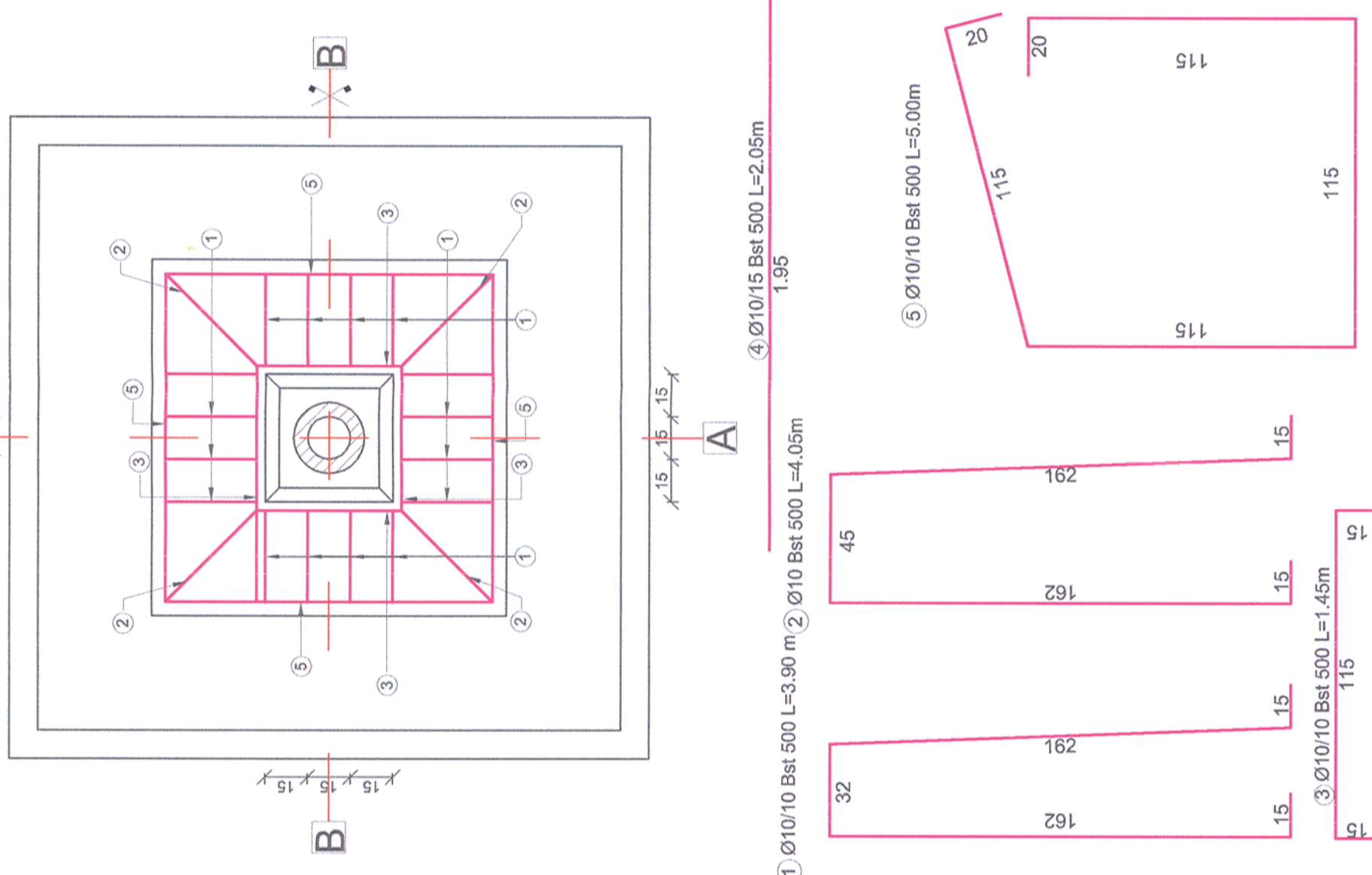

Nr.	Diam	Lungime	Buc.	Bst 500
1	10	3,90	12	46,80
2	10	4,05	4	16,20
3	10	1,45	48	69,60
4	10	2,05	26	53,30
5	10	5,00	12	60,00
LUNGIMI/diam				245,9
Greutati Diam/ml				0,616
Greutati Kg/diam				151,5
TOTAL pe tip otel				151,5
TOTAL GENERAL				151,5

Nota
Cota ±0.00 se stabileste in functie de amplasament.
Note
±0.00 cota is established according to the location.

Materiale / Materials:

Beton armat/Reinforced concrete: C30/37
Beton simplu/Plain concrete: C12/15
Otel beton/Reinforcement: Bst 500

Proiectul de structura se va corela cu proiectul celorlalte specialitati (partea scrisa si partea desena).
The structural project (blueprints, technical briefs, technical specifications) will be correlated with the other specialities/projects (blueprints, technical briefs and technical specifications).

Note generale valabile pentru intregul proiect
Executantul este obligat sa verifice informatiile din planuri si din extrasile de laminare inainte de comandarea oricaror materiale si sa comunice orice neconcordanta proiectantului. In caz contrar proiectantul nu isi va asuma responsabilitatea pentru nici o eroare din planuri sau din extrasile de materiale.
Universal remark valid for the entire project.
The executants is bound to verify all the information from the plans and from the material lists before ordering any materials and to communicate any disparity to the designer. Other way the designer will not assume the responsibility about the errors in the plans or in the material lists.

Sectiune A-A/Section A-A

sc. 1:20

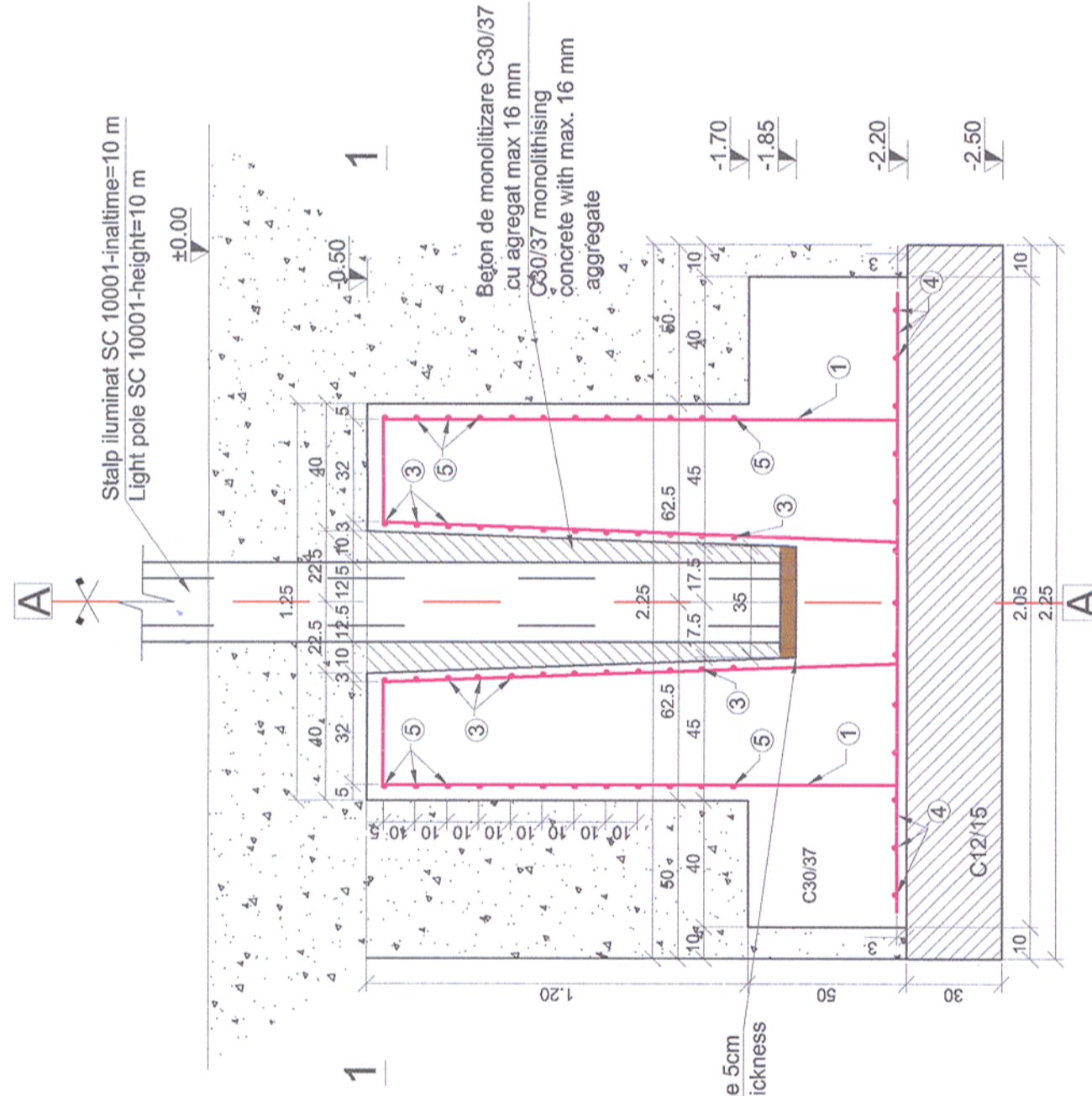

Plan fundatie stalp de iluminat-SC 10001 / Light pole foundation plan-SC 10001

sc. 1:20

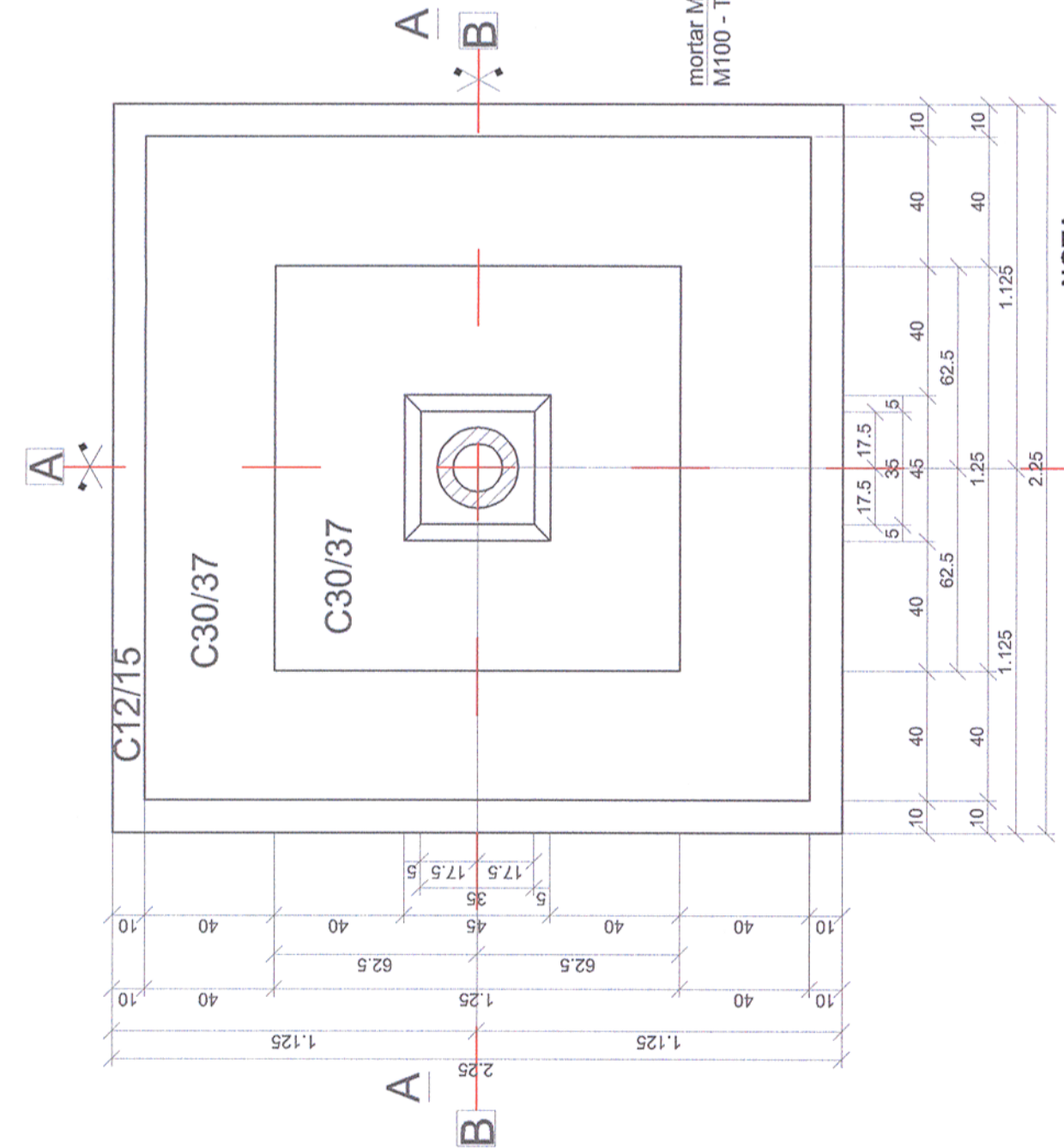

NOTA

Fundatie se va verifica prin calcul de Antreprenor dupa cunoasterea exacta a fortelor momentelor aplicate si in caz de necesitate se vor face adaptari

NOTE

The foundation will be verified through calculation by the Entrepreneur after an exact knowledge of the applied forces and moments and if necessary adjustments will be made

Toate tipurile de otel (in special Bst 500) vor avea obligatoriu clasa de ductilitate C.
All types of steel (especially Bst 500) will mandatory have the ductility class C.
Acest plan anuleaza si inlocuieste planul nr. PT.03.03.00.RE.08.001 elaborat la data 01.2013.
This layout plan canceled and replaced layout plan no. PT.03.03.00.RE.08.001 prepared on 01.2013.

Verificator / Expert Checker / Expert	Cerinta Requirement	Signatatura Signature	Expertiza Report / Expertise

MINISTERUL TRANSPORTURILOR

BENEFICIAR / BENEFICIARY :

CFR
COMPANIA NAȚIONALĂ DE CĂI FERATE "CFR" SA

PROIECTANT / DESIGNER:		PÖYRY	Data Date	Semnătura Signature
Aprobat Approved	Șef de echipă Team leader	C. Teodorescu	01.2013	
Verificat Checked	Expert Cheie Key Expert	R. Witan	01.2013	

Subcontractant / Subcontractor		MIOTOP
Aprobat Approved	Adjunct Șef de echipă Deputy Team leader	A.M. Baicu
Proiectat Designed	Inginer Engineer	S. Petrea

"Reabilitarea liniei c.f. Frontieră - Simeria, parte componentă a coridorului IV Pan - European pentru circulația trenurilor cu viteză maximă de 160 km/h"
Tronsoanel 3. Gurasada - Simeria
"Rehabilitation of the Railway Line Border - Curtici - Simeria, component Part of the IV Pan - European Corridor for the Trains Circulation with maximum speed of 160 km/h"
Section 3: Gurasada - Simeria

Denumire desen / Drawing name:
Fundatiile stlpilor iluminati pentru container
Station Lighting poles foundation for container

Scara / Scale 1:20	Revizia / Revision 1/05.2013	Cod desen / Drawing Code PT.03.03.00.RE.08.001	Nr / No 01/01
-----------------------	---------------------------------	---	------------------